

Fisherman Bay Water Association						
Capital Improvements Plan						
Expenditure	Cost	Priority	Funding			
Well #3 Control System	2,000	Phase 1	Funds on Hand			
Corrosion Control Treatment	11,500	Phase 1	Funds on Hand			
Dedicated Well supply lines	102,800	Phase 1	Funds on Hand			
Elevated Water Storage	231,000	Phase 1	State Rev. Loan Fund New Conn. Fees			
Total Phase 1	347,300					
So. Lopez Rd. Main Ext.	42,100	Phase 2	Funds on Hand			
Additional Source Well	142,000	Phase 2	Connection Fees			
Total Phase 2	184,100					
Capital Improvements Program	Actual FYE 08	Projected 09	Projected 10	Projected 11	Projected 12	Projected 13
Expenditures						
New CIP Facilities		102,800		115,500	115,500	142,000
Renewal and Replacement Facilities						
Safe Drinking Water Act Facilities	13,500					
Capital sources						
Loan/Bond Funds				231,000		
Grants						
Special Charges						
Withdrawal From Reserves	13,500	102,800				142,000
Net CIP	0	0		-115,500	0	0
Approved ERU's	140	225			400	

Lopez Village

Water and Sewer Service Areas

EXHIBIT 2

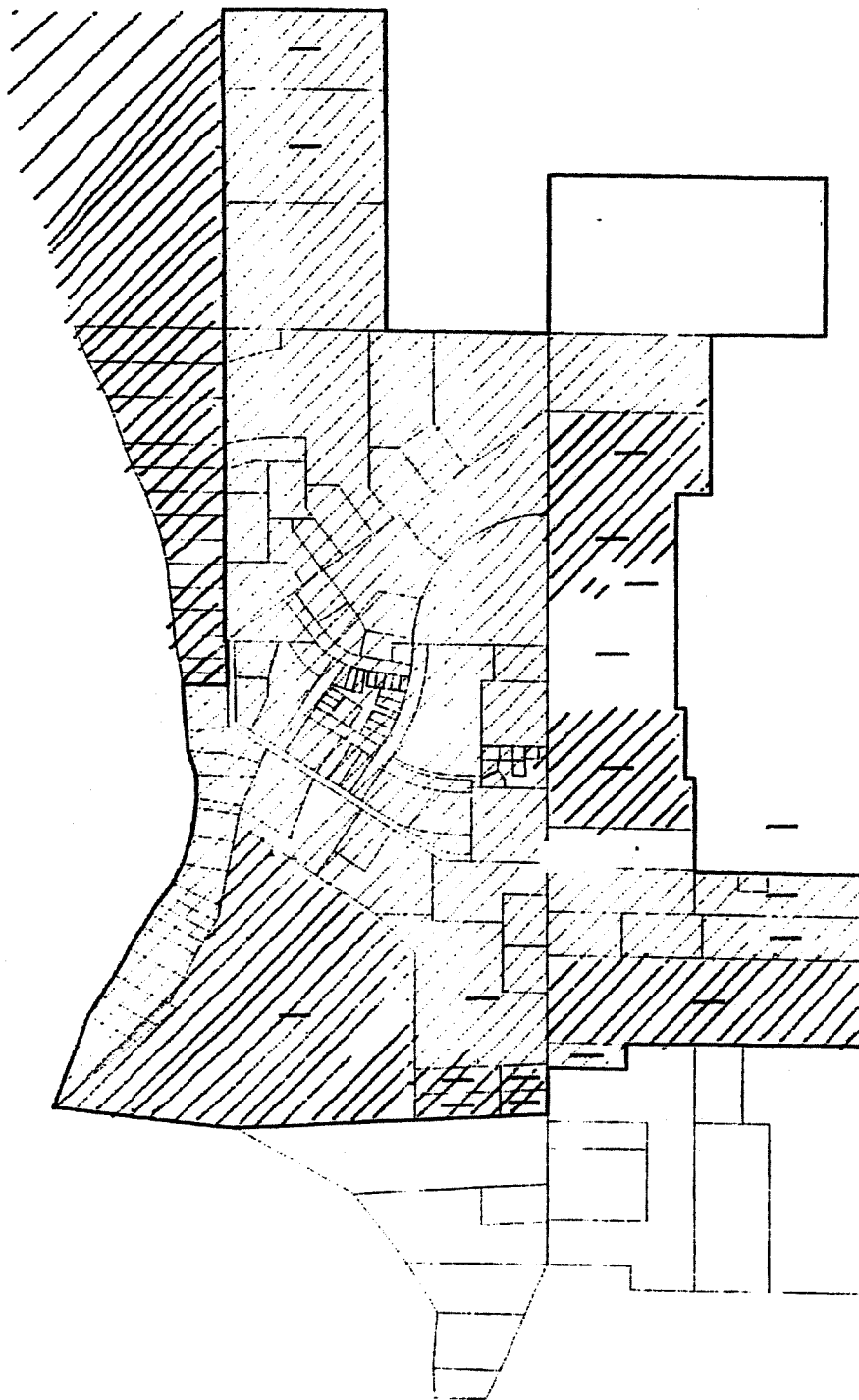

- Village Boundary
 - Sewer Service Area
 - Lopez Village Area
 - ▨ Milagra Water System
 - ▧ Fisherman Bay Water User Assoc.
- as amended 3/2008*

Milagra Water System Parcel Numbers

251420001000	251451067000
251422000000	251451068000
251423000000	251451069000
251451001000	251451010000
251450002000	251451011000
251450003000	251451012000
251450004000	251451013000
251450005000	251451014000
251451002000	251451015000
251451003000	251451016000
251451004000	251451017000
251451005000	251423011000
251451006000	